

DC141: Directional Coupler for Coaxial Waveguide 23/47

General description

DC141 is a directional coupler intended for sampling incident or reflected waves in high-power 2450 MHz industrial applications using 23/47 mm coaxial waveguide. The coupler is fixed to the waveguide with six M3 or similar-diameter screws after machining of appropriate holes in the special waveguide part with platform. Simple reversing the coupler causes it to sample the wave propagating in the opposite direction.



Specifications

Frequency range	2425 - 2475 MHz
Coupling factor	-60 dB \pm 1 dB standard (lower coupling factors available upon request)
Directivity	25 dB min.
Output connector	N-F (SMA-F available upon request)
VSWR (SMA)	1.25 max.
Waveguide of destination	Coaxial (inner diameter 23 mm / outer diameter 47 mm)

Dimensional drawing - N-F type connector (all units in millimeters)

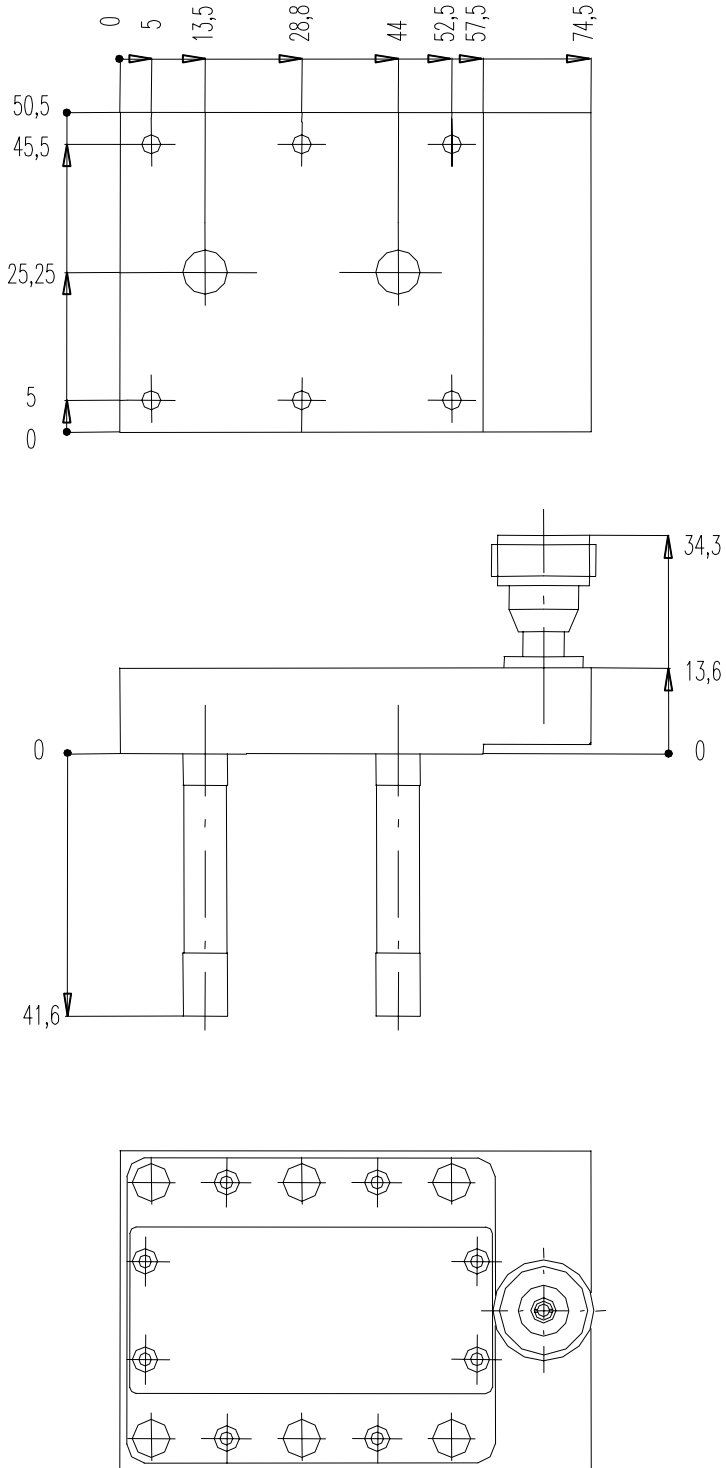

Dimensional drawing – SMA-F type connector (all units in millimeters)

